

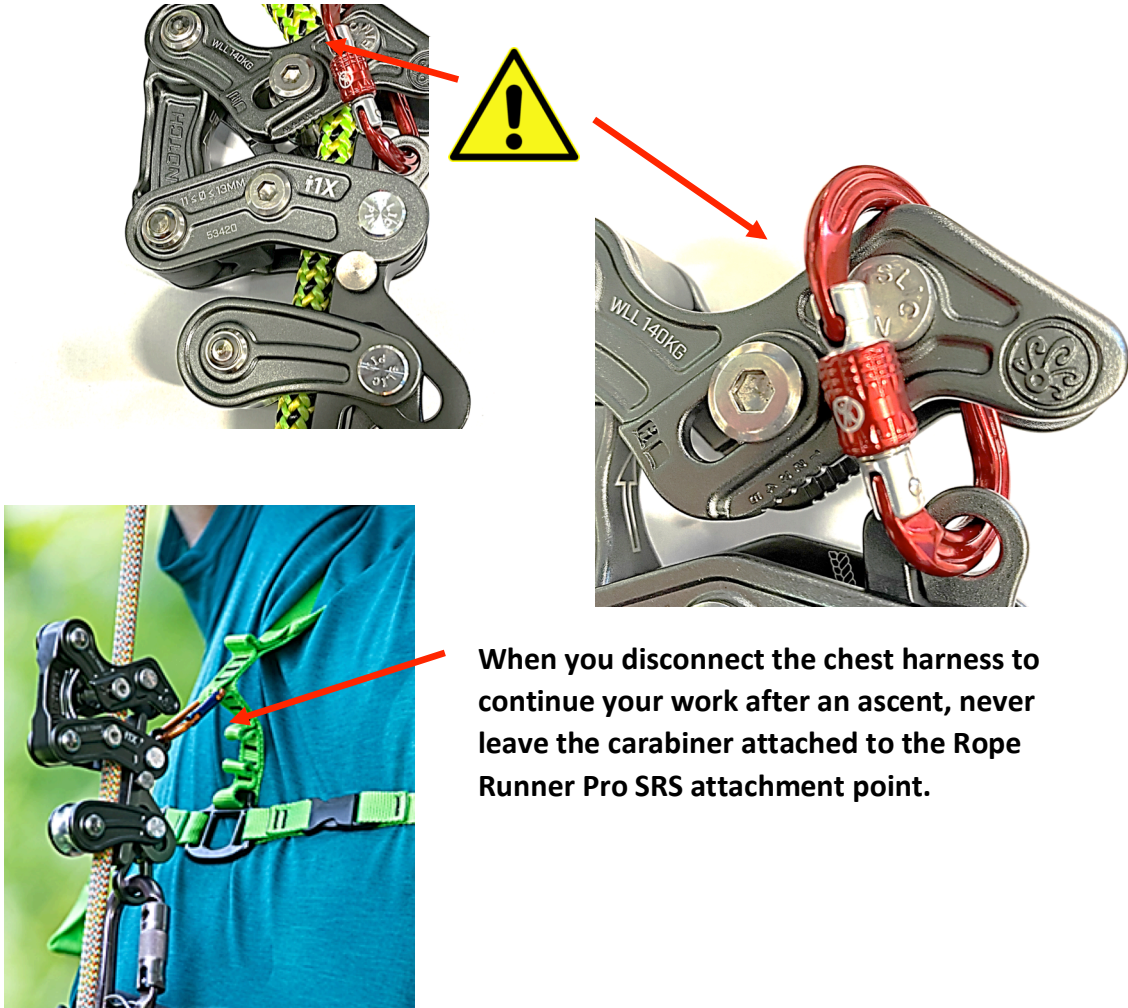

An issue has been brought to our attention that can occur as a result of an incompatibility issue between a carabiner and the Roper Runner Pro. In some instances, when left in the SRS attachment point after ascending a rope, it is possible for a carabiner or alternative connector to inadvertently interfere with the normal function of the device and lock the device in the open position.

Item#	Description
53420	Rope Runner Pro



**When you disconnect the chest harness to continue your work after an ascent, never leave the carabiner attached to the Rope Runner Pro SRS attachment point.**

This is not a defect or warranty issue with the device, rather an alert to notify end users of an improper use issue between the Rope Runner Pro and the carabiner or alternative connector, when the connector is left in the SRS attachment point after disconnecting from the chest harness.

Notch Equipment  
496 Gallimore Dairy Rd, Ste D  
Greensboro NC 27409  
info@notchequipment.com